

Outdoor

Outdoor

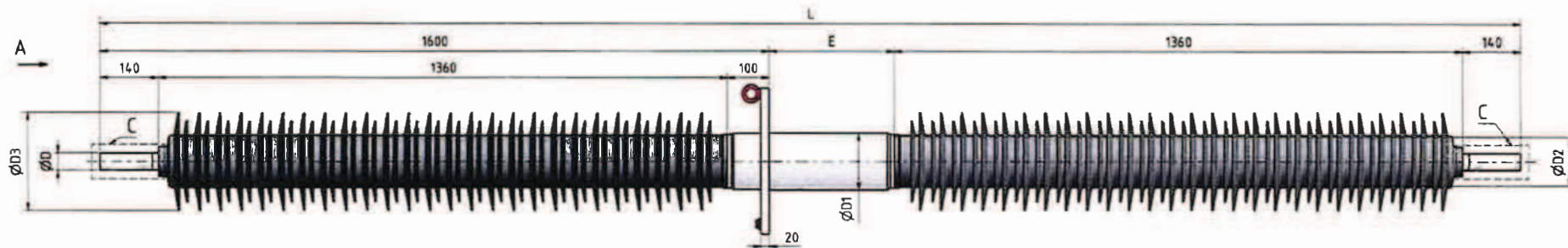

C1

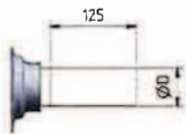

Ir = 1250A

C2

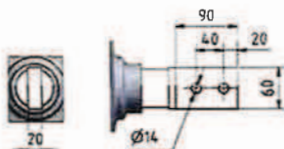

Ir = 1250A

C3

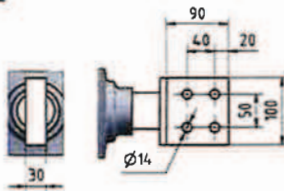

Ir = 3150A

Article-no.	Ir	Ith(t=1s)	Id	L	E	ØD	ØD1	ØD2	ØD3	F1	F2	Weight	cantilever test load	connection	connection finishing	selection
<b>701.16.0029.B01</b>	<b>1250A</b>	<b>31.5 kA</b>	<b>80 kA</b>			<b>40</b>	<b>135</b>	<b>115</b>	<b>233</b>	<b>350</b>	<b>300</b>	<b>93kg</b>	<b>3150N</b>	<b>C1</b>	<b>blank</b>	
701.16.0029.B02														C2	blank	
701.16.0029.B03	2000A	50 kA	125 kA	3400	300	70	170	150	272	350	300	134 kg	4000N	C3	blank	
701.16.0029.B04	2500A	63 kA	160 kA												blank	
701.16.0029.B05	3150A	80 kA	200 kA											C3	tin-plated	
701.16.0029.B06	1250A	31.5 kA	80 kA			40	135	115	233	350	300	98 kg	3150N	C1	blank	
701.16.0029.B07														C2	blank	
701.16.0029.B08	2000A	50 kA	125 kA	3600	500	70	170	150	272	350	300	142 kg	4000N	C3	blank	
701.16.0029.B09	2500A	63 kA	160 kA												blank	
701.16.0029.B10	3150A	80 kA	200 kA			110	220	200	321	400	350	211 kg	4000N	C3	tin-plated	

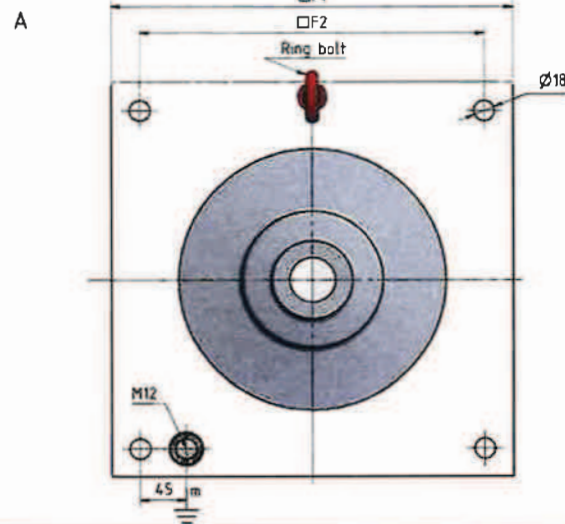

Technical Data		According to	
		IEC 60137:2006	IEEE Std C57.101-2000
Insulation Voltage (Um)	145 kV	138 kV	
Rated maximum line-to-ground voltage (U <sub>lg</sub> )	84 kV	88 kV	
Rated frequency (Hz)		50/60 Hz	
Power frequency voltage withstand (U <sub>1</sub> )	50Hz/1min Dry/Wet	275/275 kV	275/275 kV
Lightning impulse withstand voltage (U <sub>imp</sub> )	1.2/50µs	650 kV	650 kV
Switching impulse (U <sub>si</sub> )	250/250µs		
Partial discharge level (pFd)	at 135 µmV / s	88 kV	84 kV
Insulator		Sixcore light grey	
Revision		IEC 60815	
Version 1989 (SC0)		30mm/kV	
Version 2008 (S/SC0)		53 mm/kV	
Creepage distance		4495 mm	
Conductor		Aluminum	
Operating Conditions			
Installation altitude		1000m	
Ambient temperature		-45 / +40°C	
Mounting angle		0-90°	
Tel: ex 267 01 00 7368-1 (2)		PAGE	1 / 1
		WEIGHT:	SCALE
		DPA wall bushing	
		Outdoor-outdoor	
		15kV	
		DRAWING NO	REVIS OF
		701.16.0029	-
REV	DESCRIPTION	DATE	NAME